



QUALITY... PLAIN & SIMPLE®

Throttle Cable Installation Instructions

Carbureted, Select EFI Applications,
and Ford EFI (1986-1993)

General Installation Notes:

Please read these instructions completely before beginning the installation. If you have any questions, please call.

Before beginning the installation, disconnect the negative battery cable and use wheel chocks to block the vehicle's wheels. Do not attempt to install or adjust the throttle cable while the engine is running.

Make sure the engine, transmission, body and frame are properly grounded. We recommend using anti-seize lubricant on any aluminum threads.

All Lokar Installation Instructions can be found by visiting www.lokar.com/instructions.html.

NOTE: The Lokar Throttle Cable is designed to be installed with a Lokar Throttle Pedal and a Lokar Cable Mounting Bracket appropriate for your particular carburetor or fuel injection system. The Lokar Throttle Cable is designed to be cut-to-fit.

Step 1: Install the Lokar Throttle Pedal and Cable Mounting Bracket first, following the instructions provided with those parts.

Step 2: The hole in the firewall must line up with the hole in the upper arm on the Throttle Pedal. Determine exactly where the Throttle Cable needs to pass through the firewall and drill a 5/16" hole.

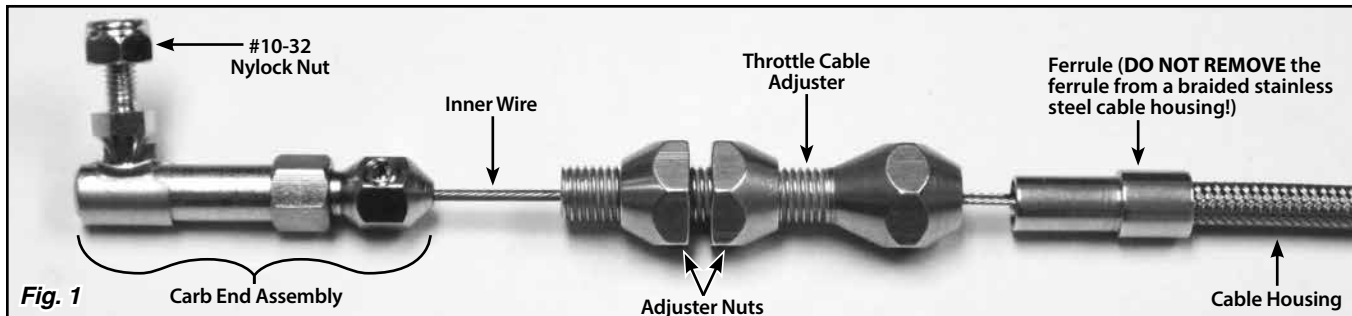

Throttle Cable Installation Instructions

Carbureted, Select EFI Applications, and Ford EFI (1986-1993)

Building American Quality... With A Lifetime Warranty!®

TOLL FREE 1-877-469-7440 • tech@lokar.com • www.lokar.com

Step 3: Remove the carb end assembly and throttle cable adjuster from the engine end of the new Lokar Throttle Cable. **DO NOT REMOVE** the ferrule if the cable housing is braided stainless steel! Pull the inner wire out of the cable housing. **Fig. 1**

Step 4: On the pedal end of the cable housing, remove the adjuster nut from the firewall fitting. Insert the firewall fitting through the firewall from the engine side, and reinstall the adjuster nut. **Fig. 2**

NOTE: The firewall fitting **MUST** point directly at the hole in the top of the upper arm of the throttle pedal so the inner wire does not rub excessively against the inside of the firewall fitting. Some Direct Fit Lokar Throttle Pedals for specific applications come with additional hardware to aid in alignment. Refer to your Throttle Pedal installation instructions for further information.

Step 5: Remove the front adjuster nut from the throttle cable adjuster and insert the throttle cable adjuster into the Cable Mounting Bracket. (**NOTE:** If a Lokar Kickdown Kit is being used, install the kickdown mounting bracket onto the back side of the Cable Mounting Bracket first.) Then, position the rear adjuster nut so the threaded part of the throttle cable adjuster is approximately centered in the Cable Mounting Bracket. Reinstall the front adjuster nut. **Fig. 3**

Step 6: Make sure the inner wire is removed from the cable housing. If the cable housing is braided stainless steel, slide the ferrule up the housing towards the firewall, away from the end being cut. **Fig. 4**

DO NOT REMOVE the ferrule from a braided stainless steel housing!

If the cable housing is black universal or Vintage Series, remove the ferrule.

Measure the distance between the throttle cable adjuster and the firewall fitting. Add 2" to the measurement and mark the cable housing at that length.

NOTE: The cable housing must **not** be straight between the throttle cable adjuster and the firewall. There must be some slack to allow for engine movement.

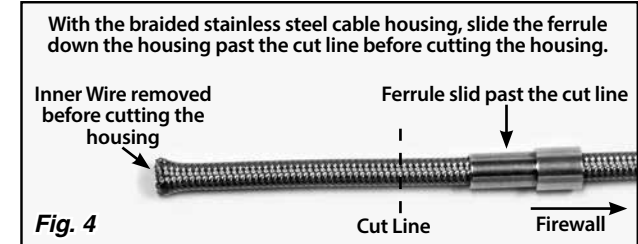
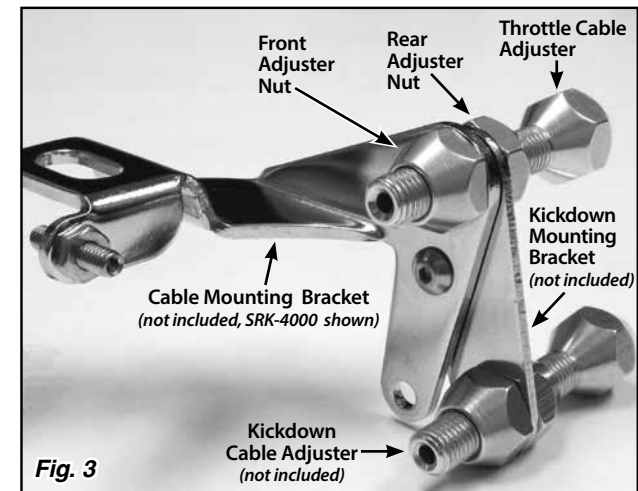
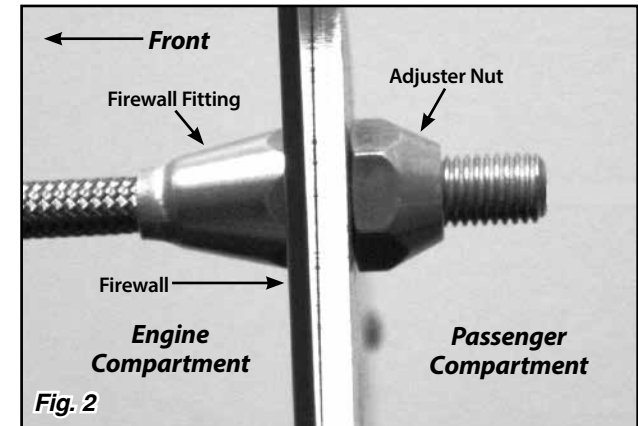

Throttle Cable Installation Instructions - Carbureted, Select EFI Applications, and Ford EFI (1986-1993)

Step 7: If the Throttle Cable has the braided stainless steel housing, wrap tape around the cable housing at your mark and use a cutoff wheel or fine-toothed hacksaw to cut the cable housing. If the Throttle Cable has the black universal or Vintage Series housing, cut the cable housing at your mark with heavy duty 8" diagonal cutting pliers or a hacksaw. Lokar recommends Klein brand Diagonal Cutting Pliers, # D2000-28 available at The Home Depot or through W. W. Graingers, part # 4A838.

After cutting the cable housing, put the ferrule back in place at the end of the cable housing. Insert the cable housing and ferrule into the throttle cable adjuster.

NOTE: If you are connecting the Lokar Throttle Cable to an OEM or aftermarket pedal that requires a ball end on the cable, the clevis can be removed by sliding it off of the inner wire at this time.

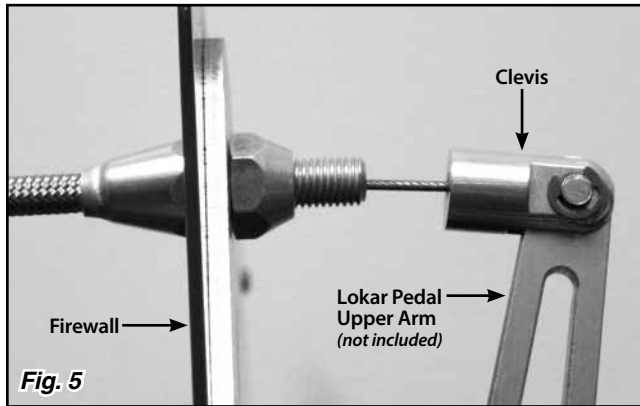

Step 8: Reinstall the inner wire into the cable housing from inside the passenger compartment. Connect the clevis (or the ball end if the clevis was removed) on the new Lokar Throttle Cable to the Throttle Pedal. Fig. 5

Step 9: Attach the carb end assembly to the throttle arm. Tighten the #10-32 nylock nut. Adjust the carb end assembly so approximately 3 or 4 of the adjustment threads are exposed. Cut the inner wire off so roughly 1" of the inner wire will remain inside the carb end assembly.

Step 10: Insert the inner wire into the carb end assembly. Pull all the slack out of the inner wire and tighten the set screw in the carb end assembly.

Check for proper operation of the throttle (and Kickdown if equipped) and adjust as necessary. Make sure there is no binding in the throttle linkage and the throttle returns to the closed position when the pedal is released. With a carburetor or select EFI application, your final installation should look like Fig. 6 (optional Lokar Cable Mounting Bracket and Springs and Lokar Kickdown Kit also shown).

NOTE: Once the Throttle Cable is installed, make sure the Throttle Pedal is completely floored when the throttle is wide open. If the Throttle Pedal is not completely floored at wide open throttle, you will need to either adjust the pedal itself or install a pedal stop.

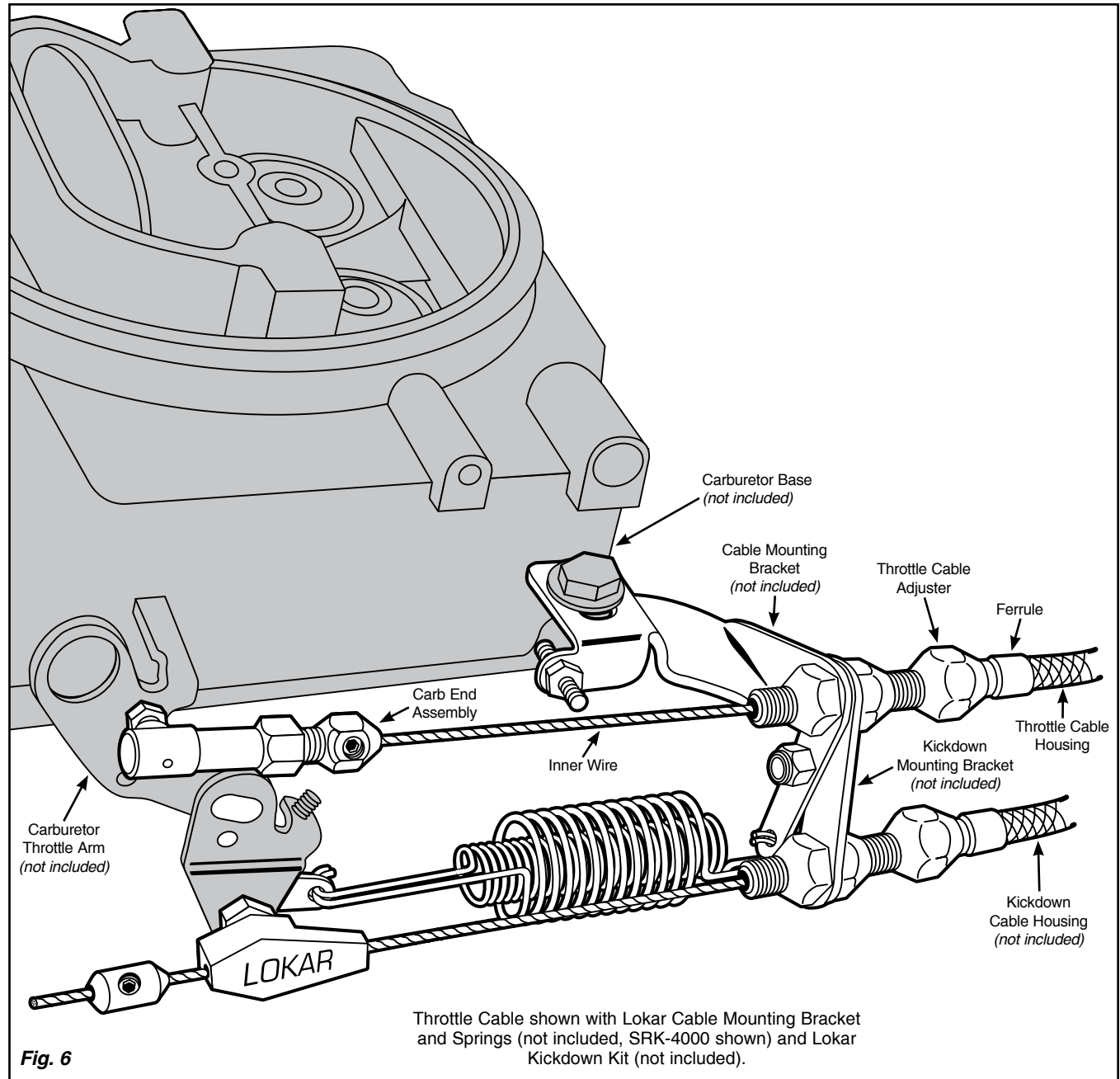

Throttle Cable shown with Lokar Cable Mounting Bracket and Springs (not included, SRK-4000 shown) and Lokar Kickdown Kit (not included).